

CASEMENT WINDOWS ALT W73 CW



MANUFACTURABILITY

Easy profile processing due to carefully engineered design;
World leading software;
Reliable technological equipment.



WARM AND SEALED

Minimum heat loss;
Different glazing options;
Unique optimized profile design for better thermal insulation;
Outstanding tightness performance.



SAFETY

PAS24 (Class W);
Advanced security with special glass fixing clip;
World leading hardware brands.



STYLISH AND INDIVIDUAL

Variety of design options;
Different surface treatment types for anodizing (bead blasting / brushing / polishing).
Wide range of RAL colours available as well as any other special powder request.

ALUTECH is the international innovative Group of companies specializing in engineering and production of architectural aluminium systems (**facades, windows, doors, patio and interior systems**). We have 5 manufacturing plants and sales operations in more than 65 countries worldwide including projects in Western Europe, the USA, Australia.

ALUTECH production capacity:

- foundry complex – more than **55 000** tons per year;
- extrusion press lines – more than **50 000** tons of profiles per year;
- coating lines – more than **47 000** tons of profiles per year;
- anodizing complex – more than **10 000** tons of profiles per year.

On the stage of initial design and during further production of ALUTECH aluminium systems we take into account main global trends in architecture worldwide. ALUTECH aluminium systems demonstrate a unique combination of beauty and functionality, innovation and tradition of the European quality.



ALUTECH Commercial UK

Knights House 2 The Parade, Sutton Coldfield, B72 1PD
+44 (0) 121 824 4788
ukcommercial@alutech-group.com
www.alutech-group.com/eu-en

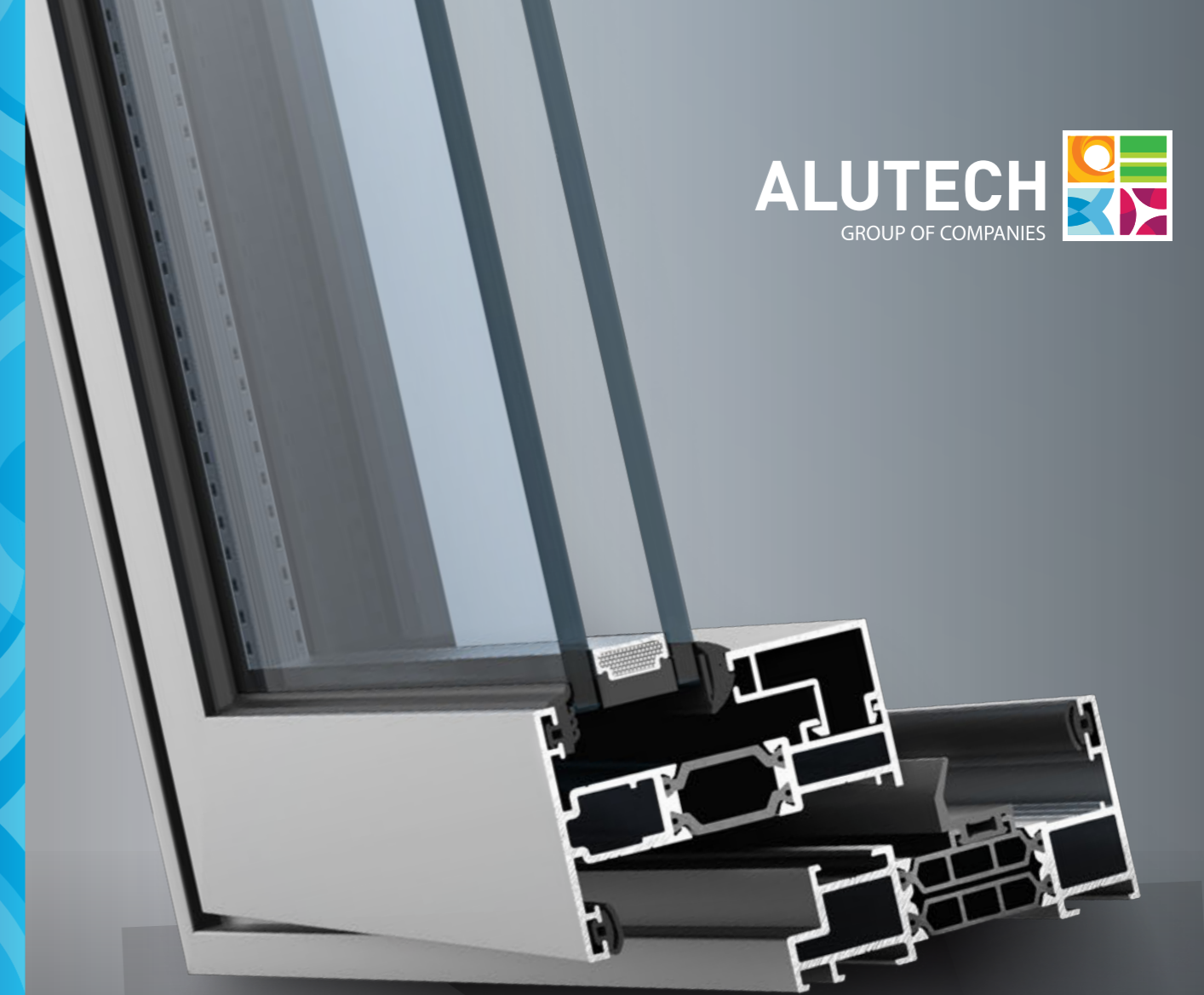

ALT W73 CW



Insulated casement windows

CASEMENT WINDOWS ALT W73CW

Our new ALT W73CW outward opening insulated window system is designed for the aesthetics and insulation requirements of both residential and commercial properties.

Slim frames and sashes create maximum glazing area to enjoy the daylight. Outstanding tightness performance and various hardware options from leading European brands provide opportunities for the fabrication of elegant, warm and safe windows.

ALT W73CW windows can be glazed from the inside as well as from the outside and also be easily integrated into **ALT F50 Curtain wall system** and **ALT BF73 Bi-folding doors**.

SPECIFICATION

- Sashes of up to 2 200 mm high and up to 1 700 mm wide
- 78 mm overall minimum visible sightline
- Glass thickness: 28–48 mm

OPTIONS

Finish

- Single and dual colour options
- Coating quality confirmed by Qualicoat/Seaside, Qualanod
- Wood grain effect options
- Special Antimicrobial BIO-coating

Hardware

Choice of handles and hinges from industry-leading brands (MACO, Kenrick, Securistyle)

TYPES OF OPENING



SASH TYPES

Slim

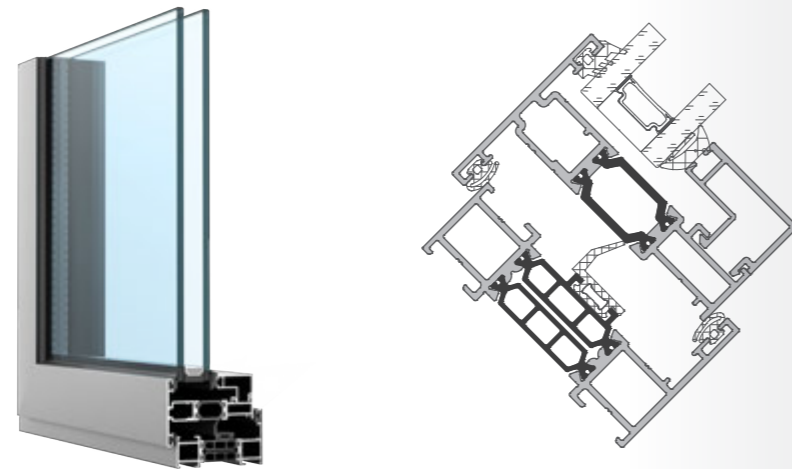

Standard

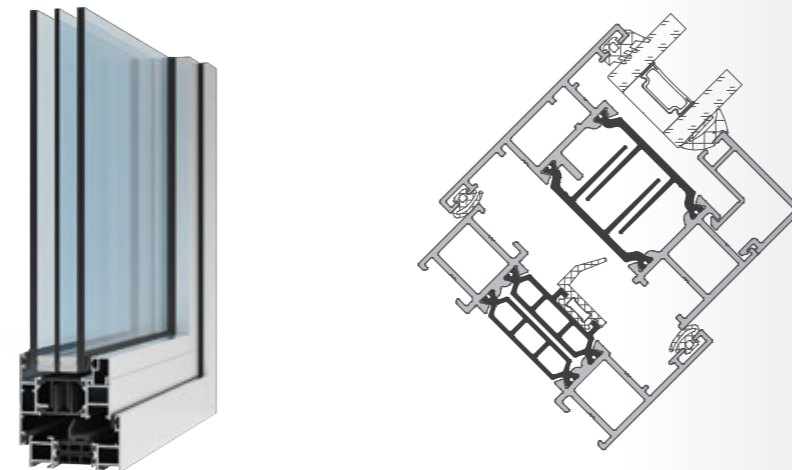

Glazing from the outside

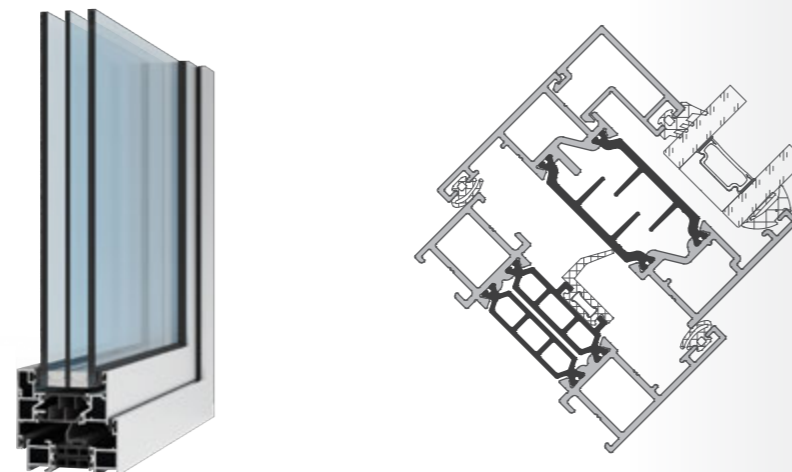

FRAME TYPES

Flush design for minimum sightline

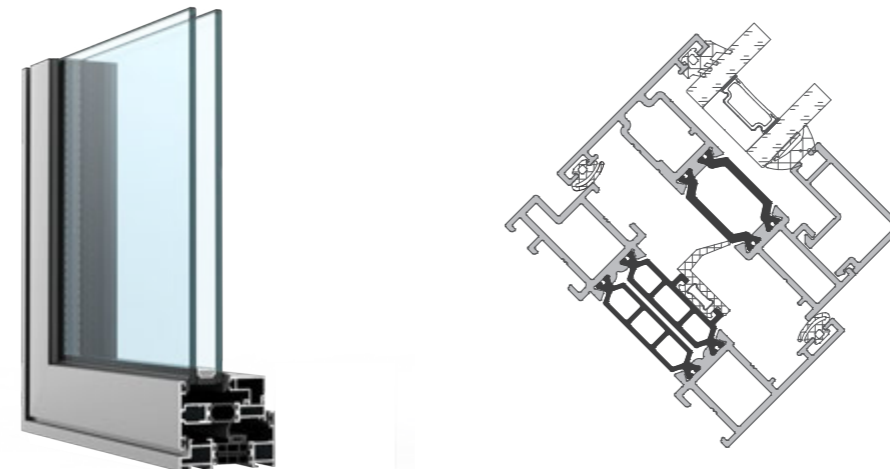

ALT F50 facade integration

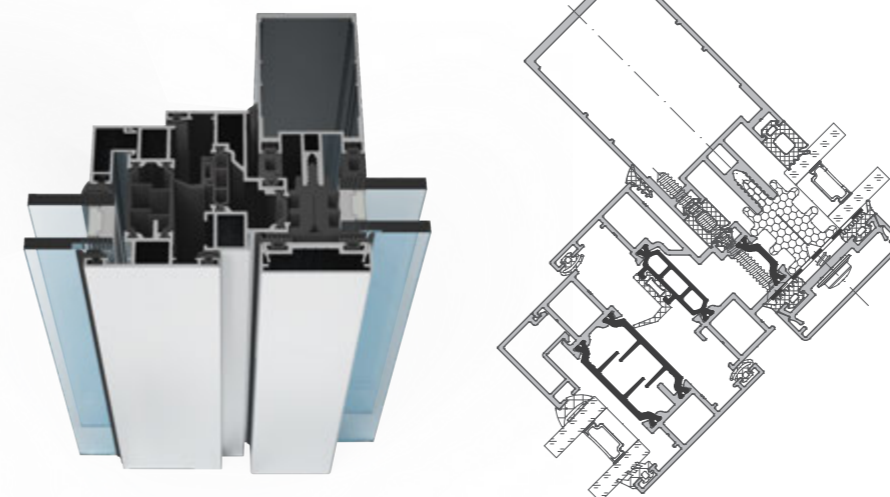

ALT BF73 bi-folding doors integration

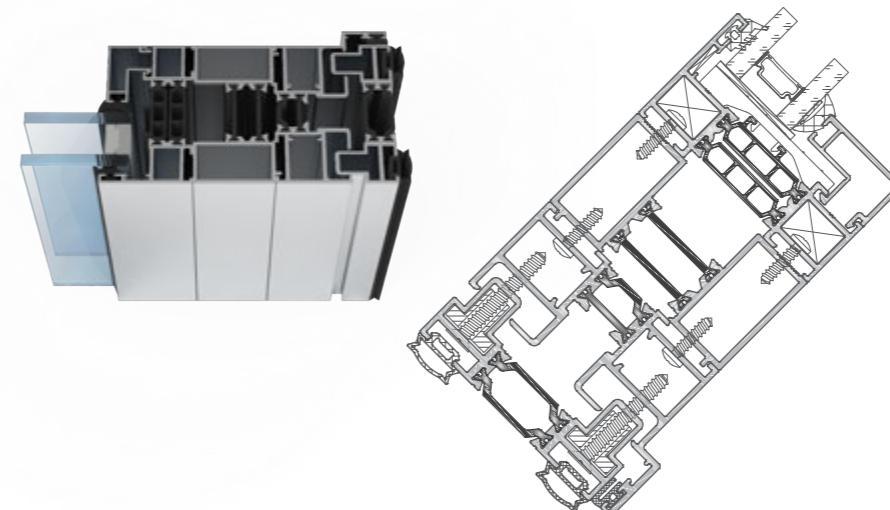

CASEMENT WINDOWS ALT W73CW

DIMENSIONS

Max. sash height	2 200 mm
Max. sash width	1 700 mm
Max. sash weight	180 kg
Glazing thickness	28–48 mm
Types of glazing	from inside and outside
Frame depth	73/81.2 mm
Sash depth	73 mm

PERFORMANCE

Thermal insulation

U_f is down to 2.38 W/(m²·K) depending on the frame/vent combination and the glass thickness

$U_w = 1.4$ W/m²·K for 1.48×1.23 m window dimensions with $U_g = 1.1$ W/(m²·K)

Comfort

Air permeability class 4 (600 Pa) EN 1026:2000, EN 12207:1999

Water tightness side hung class E1350 (1 350 Pa) top hung class E1500 (1 500 Pa) EN 1027:2000, EN 12208:1999

Wind load resistance side hung class C5 (2 000 Pa; 1/300) top hung class C3 (1 200 Pa; 1/300) EN 12211:2000, EN 12210:1999

Burglar resistance PAS 24: 2016 (class W)

GLAZING TYPES

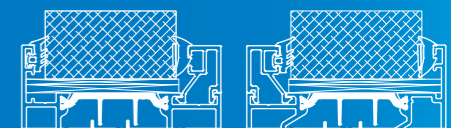

Internally glazed Externally glazed